

Court of Palms

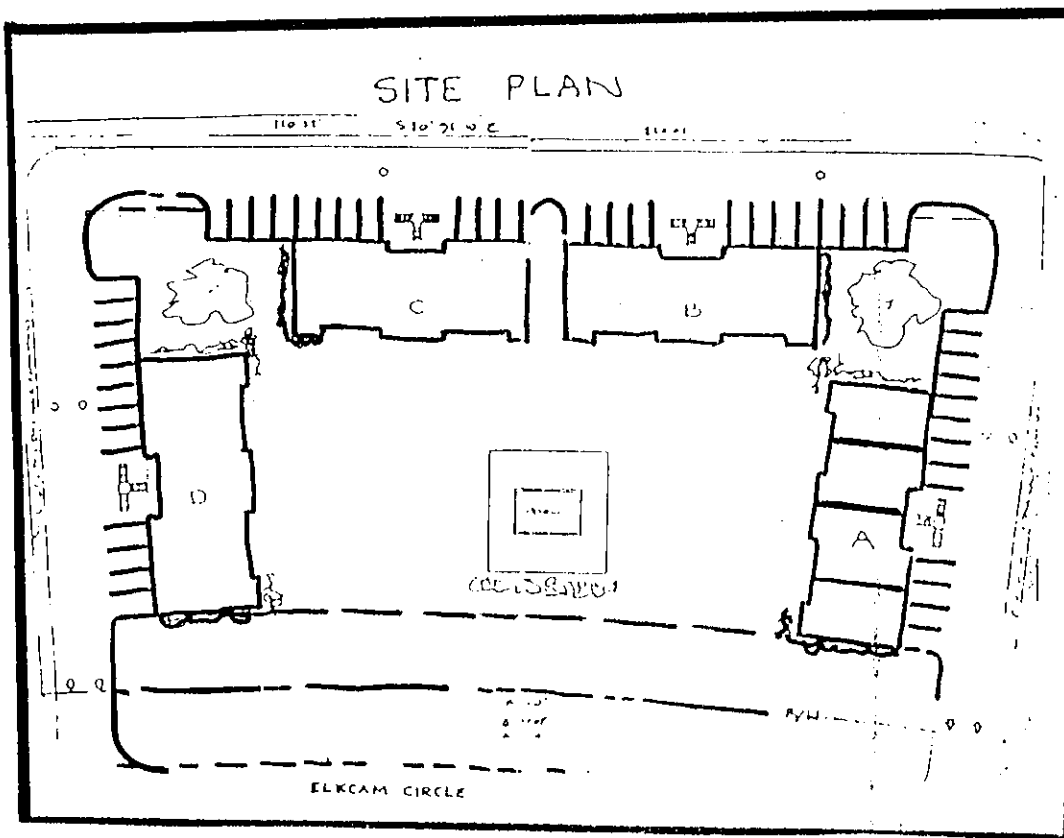
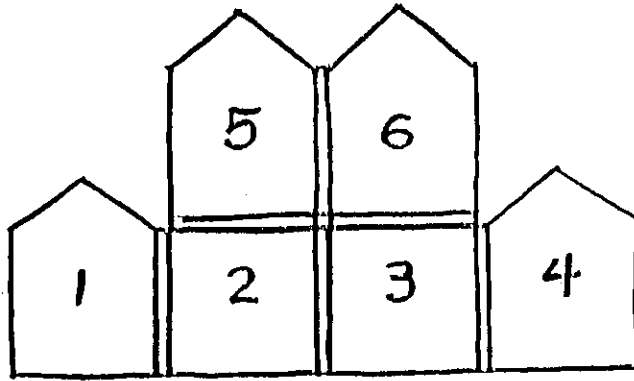

SPECIAL AMENITIES

- * Pool with Chickee Hut
- * Cathedral Ceilings on Upper floor and end units
- * Dishwasher
- * Refrigerator
- * Range with Vented Oven Hood
- * Garbage Disposal
- * Mica Kitchen Counter Tops
- * Cultured Marble Bath Vanity Tops
- * Carpet and Vinyl Allowance

SPECIFICATIONS

- * C.B.S. Construction
- * Stucco Siding
- * Pathways
- * Timberline Shingles
- * Poured Concrete - Second Floor
- * Drywall with Hardcote
- * Outside Lighting
- * Sod and Automatic Sprinklers
- * Insulated to Souther Code
- * Sound Conditioned Common Walls
- * Vented Soffits
- * Fully Landscaped... Trees, Shrubs and Hedges along front and rear

